

N10



■ CNC Control

Control system		SINUMERIK 840D sl
Drive system		SINAMICS S120

■ Working Area

Nominal length	mm	900 1300
Swing diameter	mm	560
Slidetravel X-Axis	mm	-5...+290

■ Main Spindle / Counter Spindle*

Spindle head acc. to DIN 55026	size	A6
Spindle bore	mm	54
Diameter bearing	mm	120

■ Main Spindle Drive

Driving power S6-40% /S1-100% duty cycle	kW	37,5 / 29	36 / 28
Speed range	rpm	0...6000	0...5000
Torque S6-40% /S1-100% duty cycle	Nm	190 / 250	290 / 370
Speed range of C-Axis	rpm	0...100	0...100

■ Feed Rates

Rapid feed X, Z	m/min	40 / 50
-----------------	-------	---------

■ Tool Turrets

	2-Axes	4-Axes
Number of turrets	1	2
Tool acceptance acc. to DIN 69880	30 40	30 40
Tool arrangement	axial radial	axial radial
Tool positions	12	12 / 12

■ Tailstock

Quill centre	size	MK 4
Quill travel	mm	130
Quill diameter	mm	110
Clamping force	kN	3...10

* Option

// Technical changes reserved

Top view

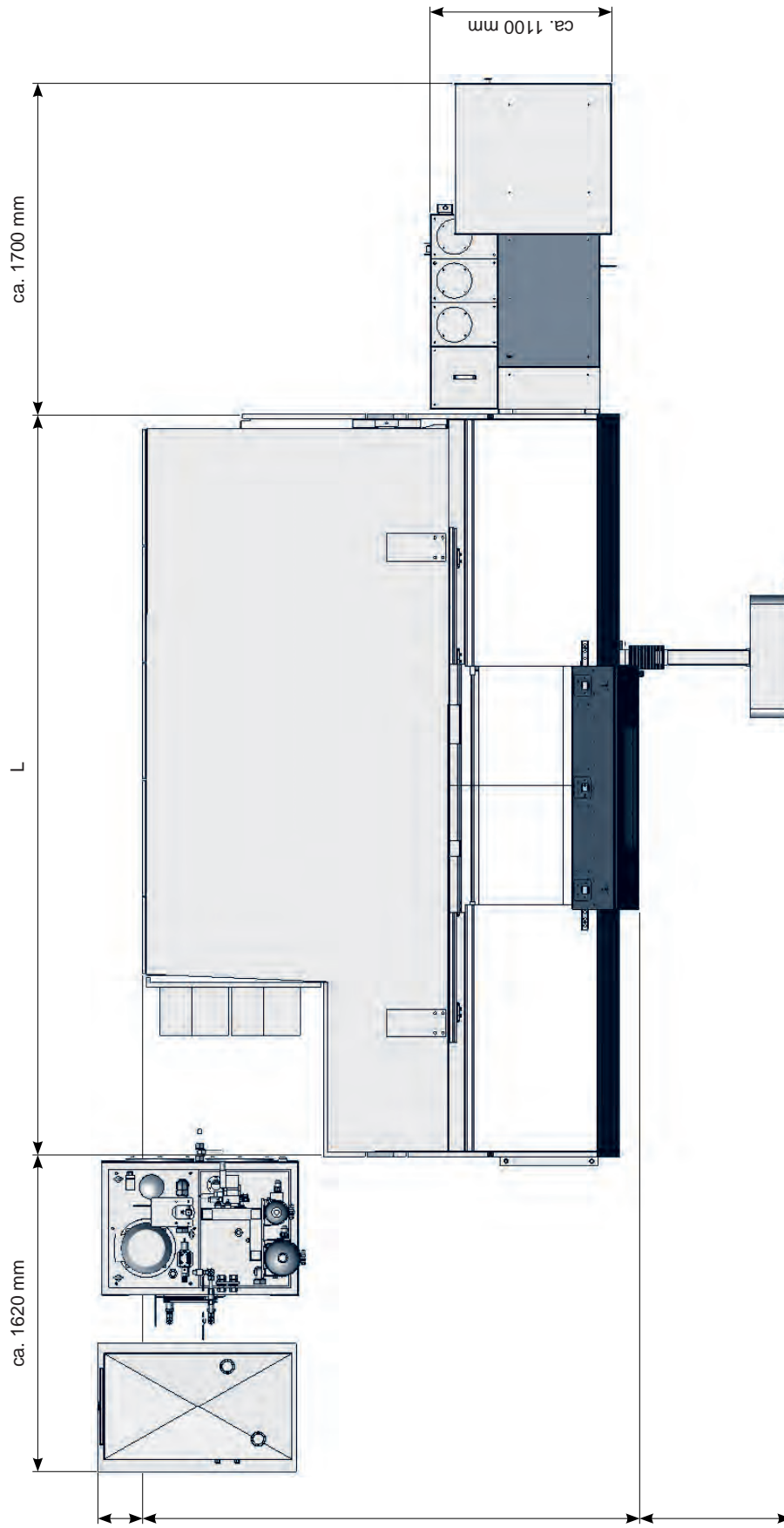

■ Nominal length	mm	900	1300
Machine length (L)	mm	3810	4210
Machine weight	ton	8,5	9,5